

REX CARY MEDICAL OFFICE

1505 SW Cary Parkway | Cary, NC 27511

AVAILABLE NOW
Lease Expires 6/30/33

Second Floor
Suite 201

2,665 SF

2nd Generation
Excellent Condition
Contains existing furnishings & equipment

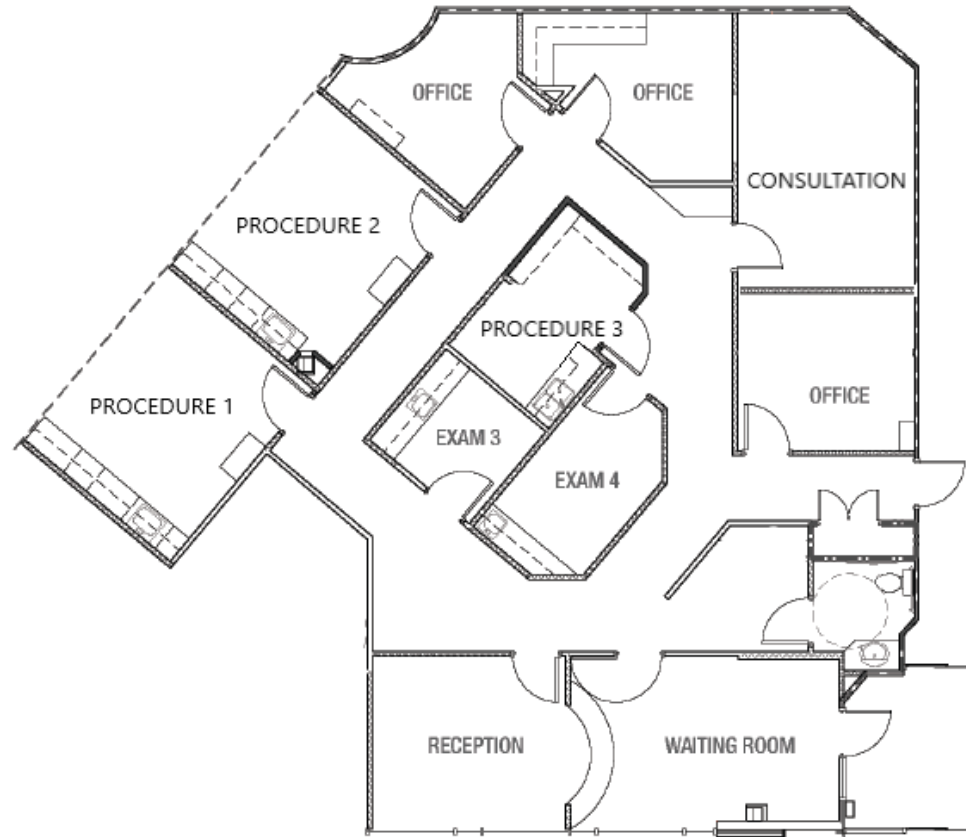

BRET MULLER

919.523.4200

bmuller@capitalassociates.com

HENRY NICHOLSON

919.417.3570

hnicholson@capitalassociates.com

