

FOR LEASE



# WESTPOINT AT 751

7806 NC Highway 751 | Durham, NC 27713



CAPITAL  
ASSOCIATES®

# WESTPOINT AT 751

7806 NC Highway 751 | Durham, NC 27713

|                      |  |
|----------------------|--|
| <b>PROPERTY TYPE</b> | Office                                 |
| <b>BUILDING SIZE</b> | 28,107 SF                              |
| <b>YEAR BUILT</b>    | 2012                                   |
| <b>COUNTY</b>        | Durham                                 |
| <b>LOCATION</b>      | Durham, NC                             |
| <b>FLOORS</b>        | 3                                      |
| <b>PARKING</b>       | 26 surface spaces<br>29 covered spaces |



**TRIPP BRADSHAW**  
919.749.0004  
tbradshaw@capitalassociates.com

# WESTPOINT AT 751

7806 NC Highway 751 | Durham, NC 27713

**AVAILABLE**

## Second Floor Suite 200

14,707 SF

Fully Furnished  
Move-In Ready

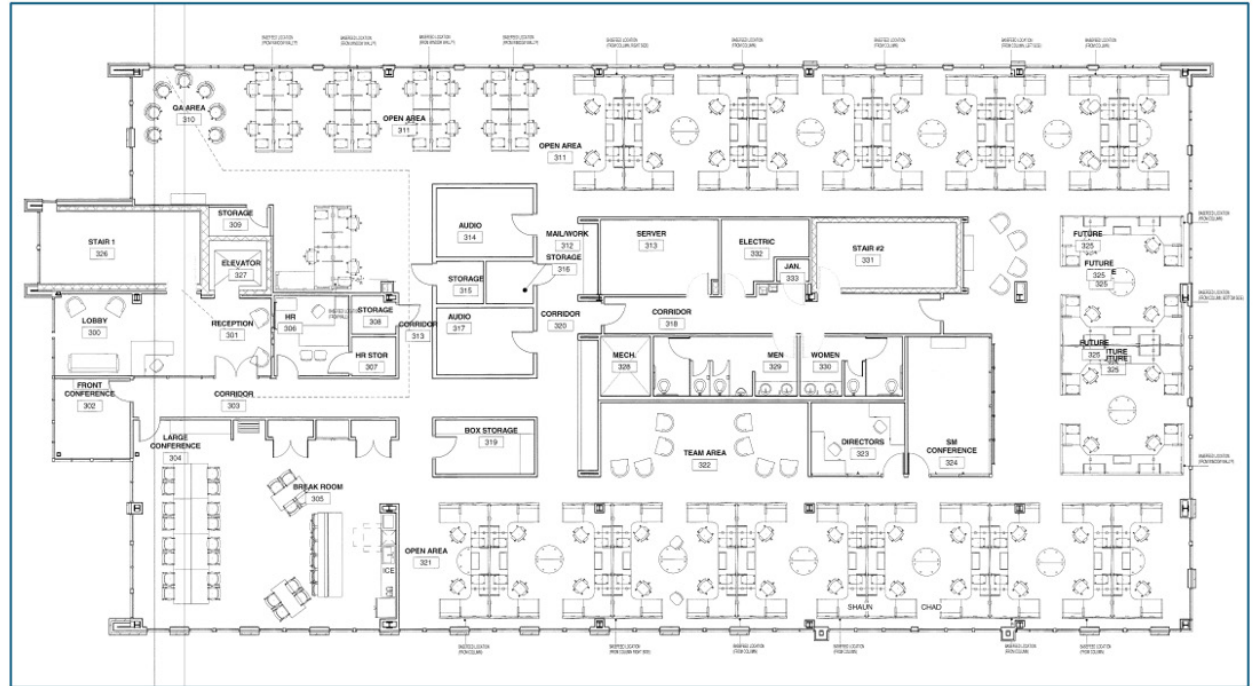

# WESTPOINT AT 751

7806 NC Highway 751 | Durham, NC 27713

## PROPERTY HIGHLIGHTS

Westpoint at 751 is a Class-A modern office property offering 1,416 SF of prime office space. Situated off Hwy 751, the building provides excellent visibility and signage opportunities. Its strategic location offers easy access to I-40, making commutes to Chapel Hill, downtown Durham, and Raleigh effortless.

- Covered and surface parking
- On-site UPS pick-up
- Outdoor seating
- Electric car charging stations
- Fully-equipped tenant fitness center with showers
- Generator available

## LOCATION

Located adjacent to The Streets at Southpoint, Westpoint at 751 is surrounded by shopping, dining, and essential services. The property is within walking distance of popular spots like Smashed Waffles, People's Coffee, Bonefish Grill, Aldi, Hyatt House, and Target, making it an ideal workplace for convenience and accessibility.

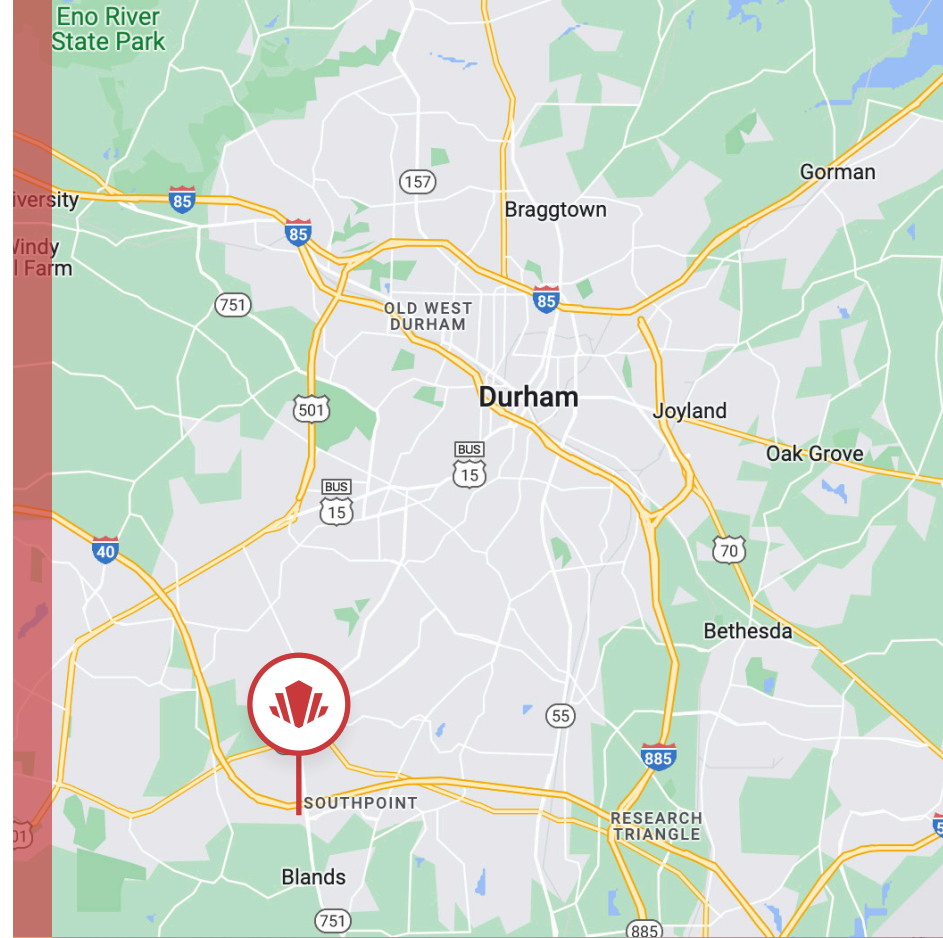

**TRIPP BRADSHAW**  
919.749.0004  
tbradshaw@capitalassociates.com

# POINTS OF INTEREST

